



## 6100 SERIES SANITARY CONVEYORS



- 1 V-groove frame with guided belt provides positive belt tracking
- 2 Belt types and materials to match application requirements
- 3 Pre-engineered accessories reduce design and setup time
- 4 1" (25) diameter head pulley is knurled for optimum drive performance
- 5 Bottom wiper continuously removes debris from belt
- 6 Sealed stainless steel bearings with FDA approved solid lubricant in both head and tail pulleys
- 7 Quick release belt tensioner allows for 5 minute belt change
- 8 Quick clamp mounting rail for convenient mounting of pre-engineered accessories
- 9 Durable 11-gauge 304 stainless steel frame is polished to a #4 finish and passivated for additional corrosion protection



## 6100 Series Sanitary Conveyors

### 6100 Series Industrial Conveyor General Specifications:

- Flat Belt and Cleated Belt
- Loads up to 60 lbs. (27 Kg)
- Lengths up to 18' (5,486)
- Widths up to 18" (457)
- CE models available

### Industries Served:

- Food
- Medical Equipment
- Electronics
- Confections
- OEM's and Integrators

### Applications:

- Packaging
- Automated and Manual Assembly
- Sortation
- Testing and Inspection
- Curing, Cooling, Heating & Cleaning
- Clean Room



## 6100 SERIES SANITARY: *FLAT BELT END DRIVE*

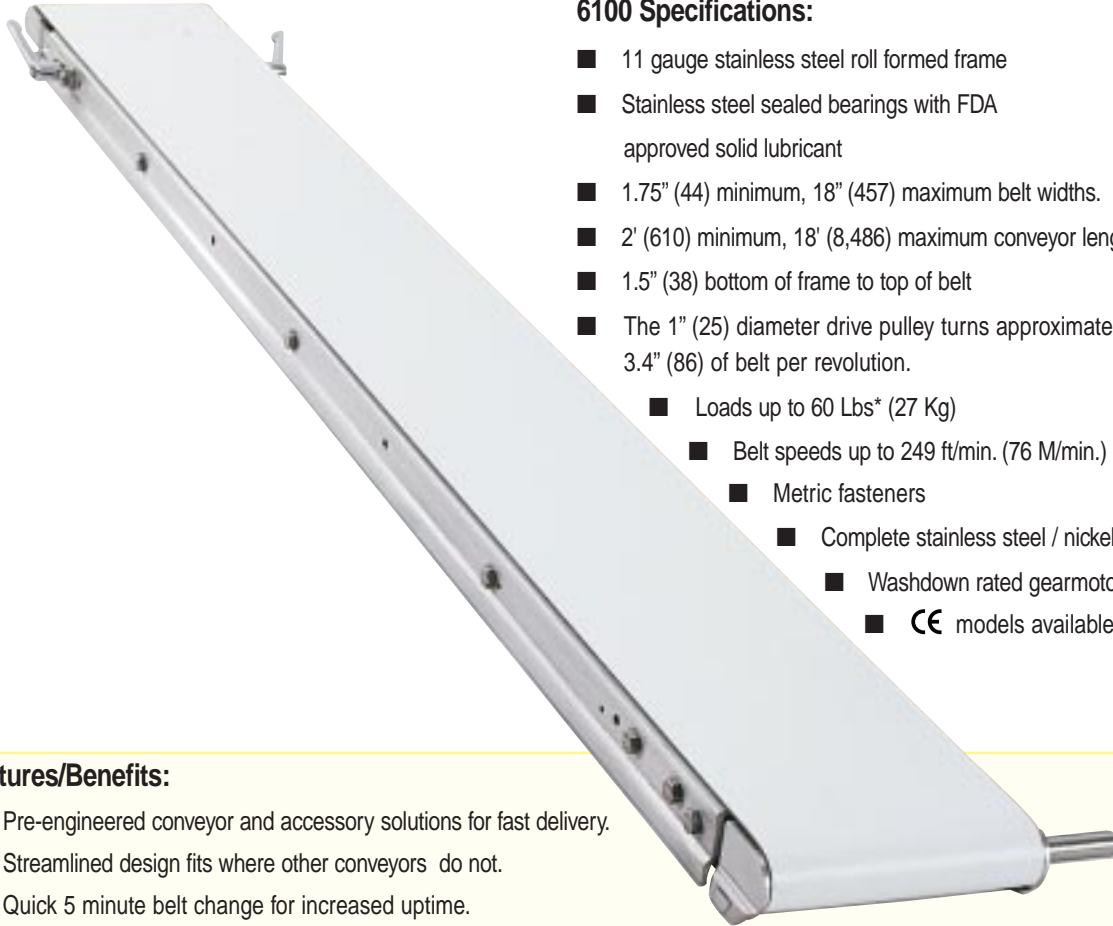

### 6100 Specifications:

- 11 gauge stainless steel roll formed frame
- Stainless steel sealed bearings with FDA approved solid lubricant
- 1.75" (44) minimum, 18" (457) maximum belt widths.
- 2' (610) minimum, 18' (8,486) maximum conveyor lengths.
- 1.5" (38) bottom of frame to top of belt
- The 1" (25) diameter drive pulley turns approximately 3.4" (86) of belt per revolution.
  - Loads up to 60 Lbs\* (27 Kg)
  - Belt speeds up to 249 ft/min. (76 M/min.)
  - Metric fasteners
  - Complete stainless steel / nickel plated construction
  - Washdown rated gearmotors and controls
  - **CE** models available

### Features/Benefits:

- Pre-engineered conveyor and accessory solutions for fast delivery.
- Streamlined design fits where other conveyors do not.
- Quick 5 minute belt change for increased uptime.
- 304 stainless steel frame, head and tail plates are polished to a #4 finish, then passivated for extra corrosion protection..
- Quick clamp rail for easy mounting of bolt-on accessories.
- Rack and pinion for fast single point belt tensioning.
- V-Groove frame with guided belt ensures accurate tracking.
- Durable 1/4" (6mm) thick bottom wiper removes debris from belt.
- A variety of FDA approved belting to meet application needs.
- Toolless belt tensioner for easy cleaning access.
- Low profile, single piece frame for quick, easy cleaning.

\* Conveyor load capacity depends on conveyor size, incline, motor position, accumulated loads and other factors. See Performance Charts / Data section for details.

### Flat Belt & Cleated Belt End Drive Conveyors feature a quick 5 minute belt change.

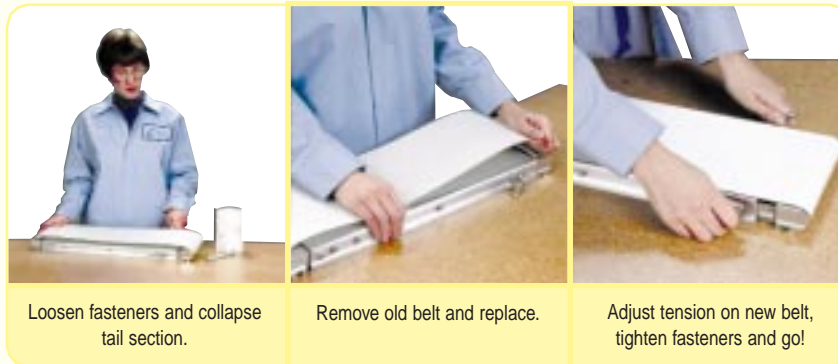

Loosen fasteners and collapse tail section.

Remove old belt and replace.

Adjust tension on new belt, tighten fasteners and go!

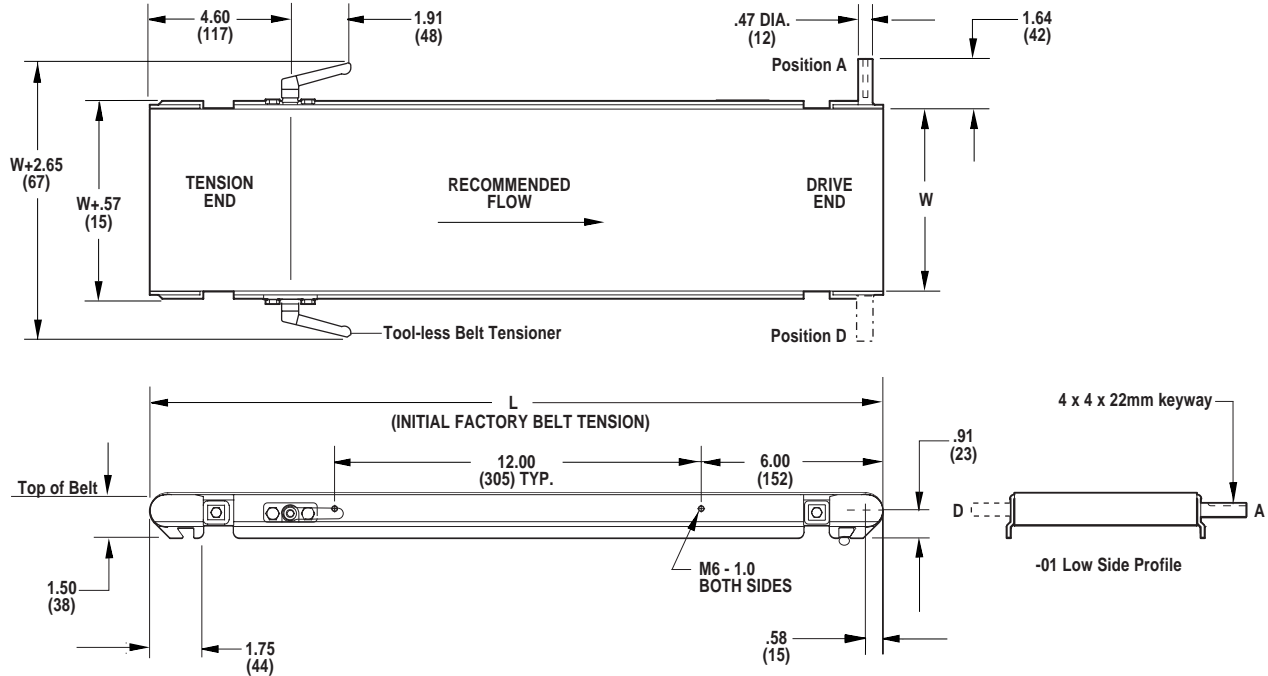

W = Conveyor Belt Width

STANDARD SIZES	
Conveyor Width Reference	02 03 04 05 06 08 10 12 18
Conveyor Belt Width (W)	1.75" (44) 2.75" (70) 3.75" (95) 5" (127) 6" (152) 8" (203) 10" (254) 12" (305) 18" (457)
Conveyor Length Reference	02 03 04 05 06 07 08 09 10 11 12 13* 14* 15* 16* 17* 18*
Conveyor Belt Length (L)	2' (610) 3' (914) 4' (1,219) 5' (1,524) 6' (1,829) 7' (2,134) 8' (2,438) 9' (2,743) 10' (3,048) 11' (3,353) 12' (3,658) 13' (3,962) 14' (4,267) 15' (4,572) 16' (4,877) 17' (5,182) 18' (5,486)

\* = These lengths available in 6" (152) and wider conveyors.

**ORDERING INFORMATION**

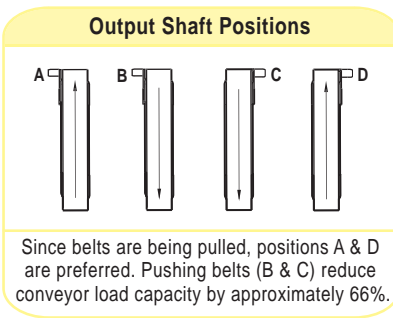
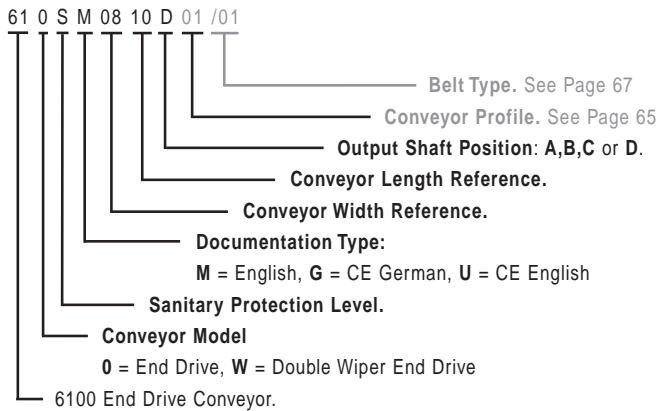

**Example:** 610SM0810D01/01

**Description:** 6100 Series Sanitary End Drive Conveyor, 8" (203) wide x 10' (3,048) long, output shaft position D, with low sides and a FDA accumulation belt and English documentation.

Note: Dimensions are represented in inches, feet, and (millimeters).

Due to the wide variety of drive set-ups and applications, point of installation guarding is the responsibility of the end user.



## 6100 SERIES SANITARY: *CLEATED BELT END DRIVE*



### 6100 Specifications:

- 11 gauge stainless steel roll formed frame.
- Stainless steel sealed bearings with FDA approved solid lubricant.
- 1.75" (44) minimum, 18" (457) maximum belt widths.
- 2' (610) minimum, 18' (8,486) maximum conveyor lengths.
- 1.5" (38) bottom of frame to top of belt.
- .47" (12 ) diameter output shaft.
- The 1" (25) diameter drive pulley turns approximately 3.4" (86) of belt per revolution.
- Load capacity up to 60 Lbs\* (27 Kg).
- Belt speeds up to 249 ft/min. (76 M/min).
- Cleats available from .24" (6) to 2.36" (60) high.
- Metric fasteners.
- Complete stainless steel & nickel plated construction.
- Motion sensor switch ready
- **CE** models available.

### Features/Benefits:

- Pre-engineered conveyor and accessory solutions for fast delivery.
- Streamlined design fits where other conveyors do not.
- Quick 5 minute belt change for increased uptime.
- 304 stainless steel frame, head and tail plates are polished to a #4 finish, then passivated for extra corrosion protection.
- Quick clamp rail for easy mounting of bolt-on accessories.
- Rack and pinion for fast single point belt tensioning.
- V-Groove frame with guided belt insures accurate tracking.
- A variety of cleat heights to meet application needs.
- Toolless belt tensioner for easy cleaning access.
- Low profile, single piece frame for quick, easy cleaning.

\* Conveyor load capacity depends on conveyor size, incline, motor position, accumulated loads and other factors. See Performance Charts / Data section for details.

### Flat Belt & Cleated Belt End Drive Conveyors feature a quick 5 minute belt change.

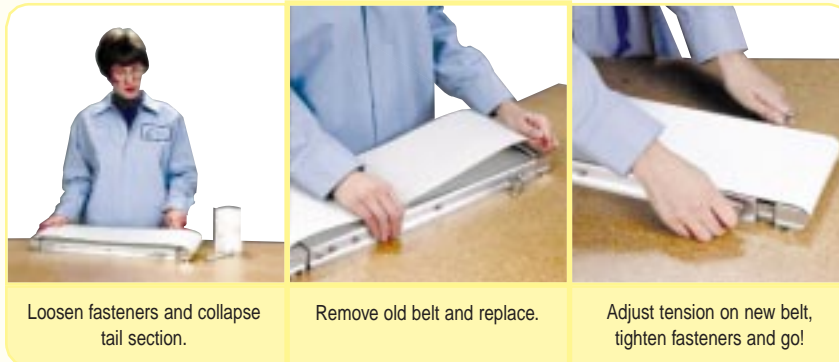

Loosen fasteners and collapse tail section.

Remove old belt and replace.

Adjust tension on new belt, tighten fasteners and go!

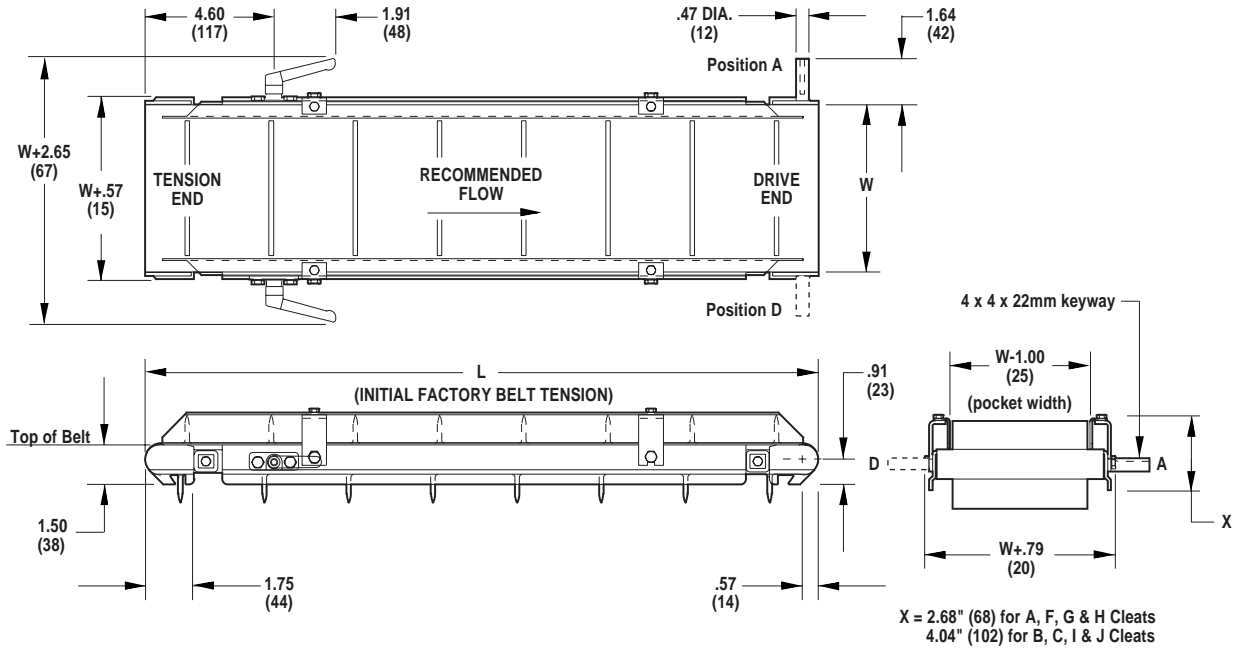

W = Conveyor Belt Width

**STANDARD SIZES**

Conveyor Width Reference	02	03	04	05	06	08	10	12	18**								
Conveyor Belt Width (W)	1.75" (44)	2.75" (70)	3.75" (95)	5" (127)	6" (152)	8" (203)	10" (254)	12" (305)	18" (457)								
Conveyor Length Reference	02	03	04	05	06	07	08	09	10	11	12	13*	14*	15*	16*	17*	18*
Conveyor Belt Length (L)	2' (6.10)	3' (9.14)	4' (1.219)	5' (1.524)	6' (1.829)	7' (2.134)	8' (2.438)	9' (2.743)	10' (3.048)	11' (3.353)	12' (3.658)	13' (3.962)	14' (4.267)	15' (4.572)	16' (4.877)	17' (5.182)	18' (5.486)

\* These lengths available in 6" (152) and wider conveyors.  
 \*\* 12' (3,658) maximum conveyor length, due to belt weight.

**ORDERING INFORMATION**

614 S M 08 10 A D 0603

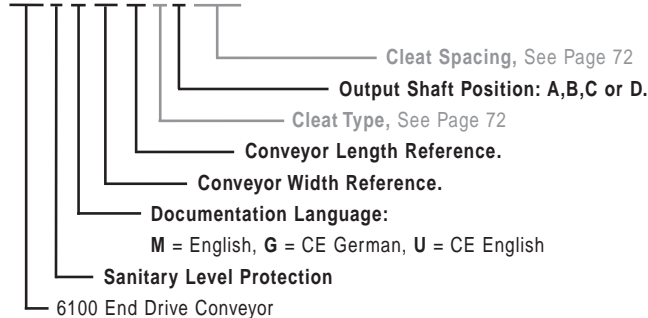

**Output Shaft Positions**

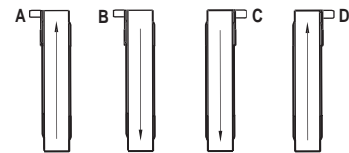

Since belts are being pulled, positions A & D are preferred. Pushing belts (B & C) reduce conveyor load capacity by approximately 66%.

**Example:** 610SM0810AD0603

**Description:** 6100 Sanitary Series Cleated Belt End Drive Conveyor, 8" (203) wide x 10' (3,048) long output shaft position D, with Type A cleated belt with cleats spaced on 6.03" (153) centers and English documentation.

Note: Dimensions are represented in inches, feet, and (millimeters).

Due to the wide variety of drive set-ups and applications, point of installation guarding is the responsibility of the end user.